

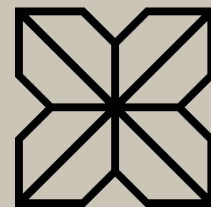

# BRENT CROSS TOWN

Public access from Brent Terrace  
Feb'21– Dec'22

Updated



**Brent  
Cross  
Town**

**Feb-21**

Vegetation clearance underway within Claremont Open Space but access through maintained.

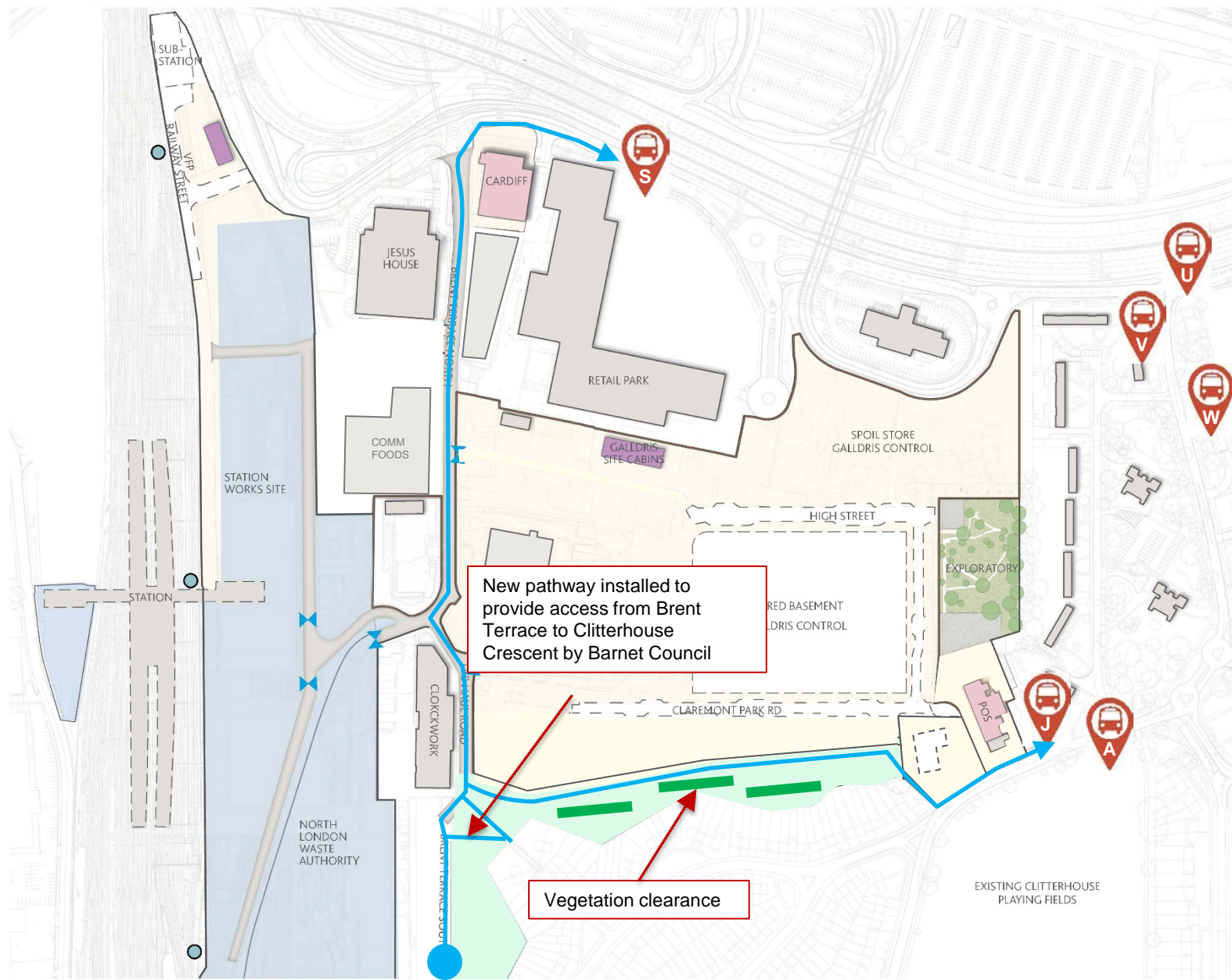

New pathway installed to provide access from Brent Terrace to Clitterhouse Crescent by Barnet Council

Vegetation clearance

- KEY
- BXS control
  - 3rd party control
  - Demolition
  - Earliest office fitout
  - Hoarding line
  - Existing use
  - Interim use opportunity
  - Site cabins
  - Interim road
  - Interim public realm
  - Completed building
  - Completed road
  - Under construction
  - NR access points (NAP)
  - Gates

PROJECT TITLE  
BRENT CROSS SOUTH GUARDIAN ROLE - TIMESLICES

DRAWING TITLE  
P12174-00-003-GIL-0104-02

SCALE  
1:1250 @A1

REVISION NO.  
02

DATE  
11 OCT 2020

**Bus Routes:**  
Stop S: 112, 142, 182, 232, 266 (All west bound only)  
Stop U: 324, 210  
Stop V / W: 102, 189, C11  
Stop A / J: 102, 189, C11  
Stop TBC: 189, 326



# Apr/May-21

Construction begins for the new Claremont Park, requiring closure of the existing access way, no earlier than 26<sup>th</sup> April

Works around the Parade of Shops & Claremont Way complete.

Works to the Visitors Centre will be ongoing.

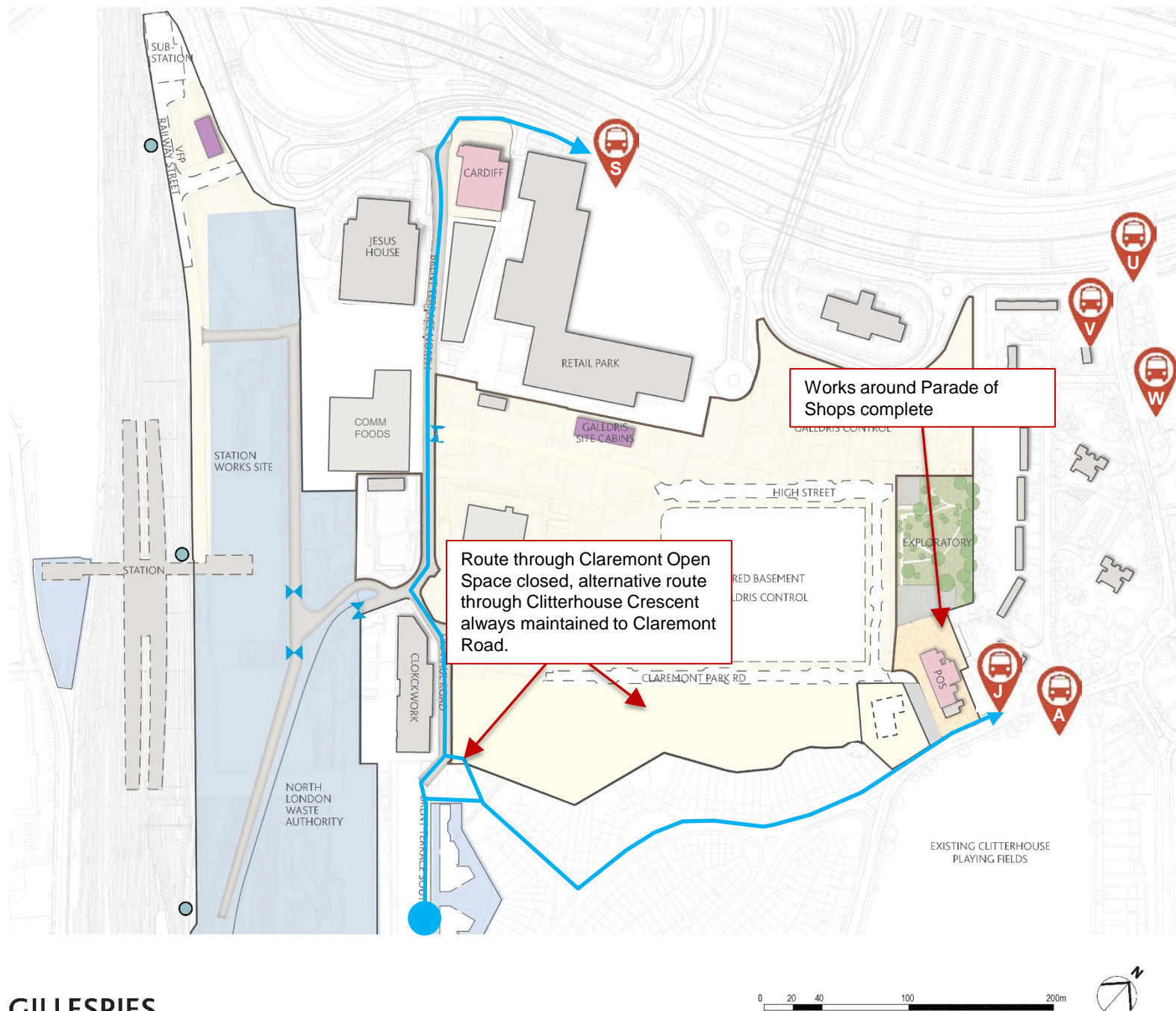

- KEY
- BXS control
- 3rd party control
- Demolition
- Earliest office fitout
- Hoarding line
- Existing use
- Interim use opportunity
- Site cabins
- Interim road
- Interim public realm
- Completed building
- Completed road
- Under construction
- NR access points (NAP)
- Gates

PROJECT TITLE  
BRENT CROSS SOUTH GUARDIAN ROLE - TIMESLICES

DRAWING TITLE  
P12174-00-003-GIL-0104-02

SCALE  
1:1250 @ A1

REVISION NO.  
02

DATE  
11 OCT 2020

**Bus Routes:**  
**Stop S:** 112, 142, 182, 232, 266 (All west bound only)  
**Stop U:** 324, 210  
**Stop V / W:** 102, 189, C11  
**Stop A / J:** 102, 189, C11  
**Stop TBC:** 189, 326

# Sept-21

Visitors Centre opens.

Access remains unchanged from April-21 although there will be disruption during the upgrade of Brent Terrace North works due to complete end of 2021.

Access up Brent Terrace North will be maintained at all times.

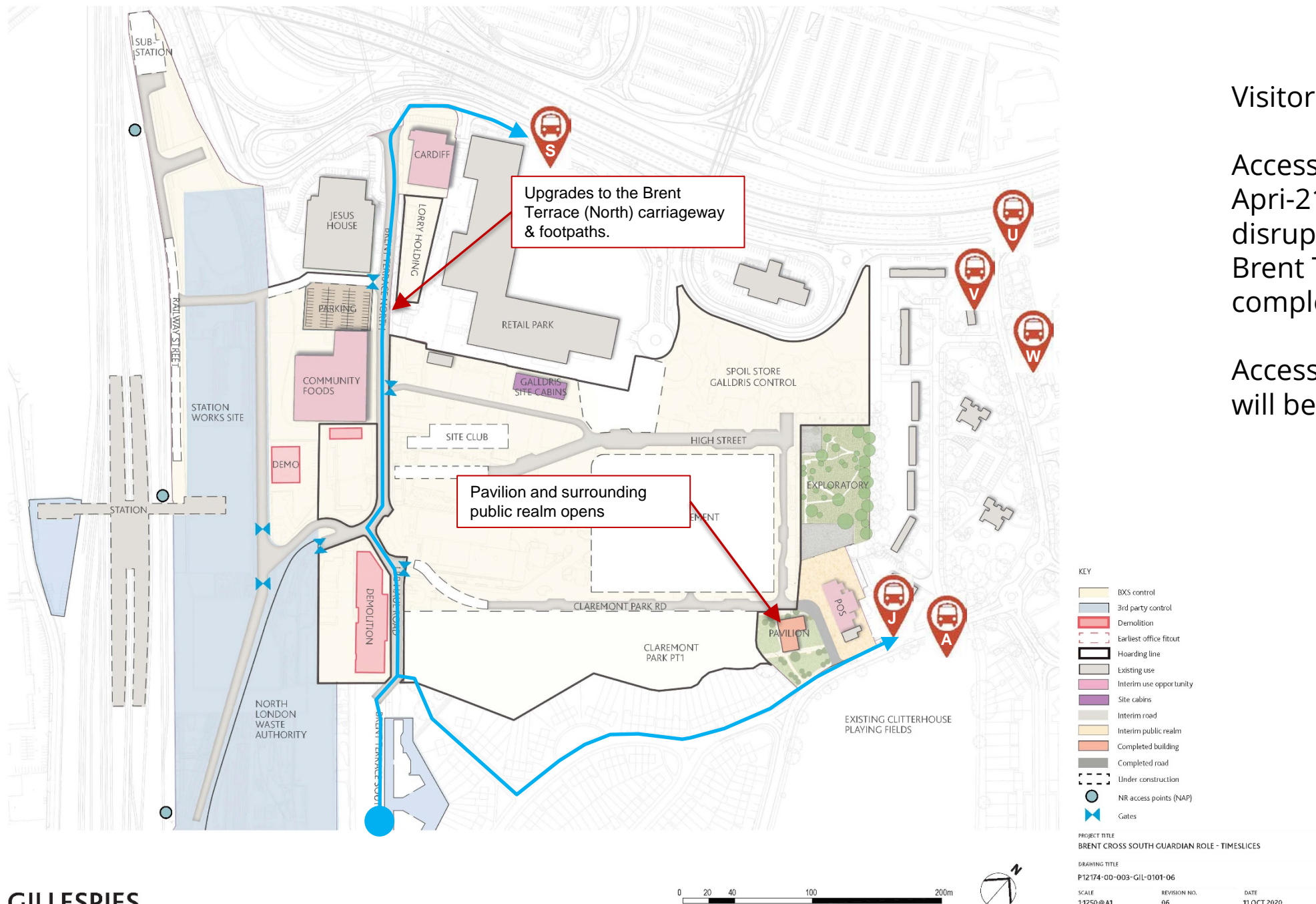

Jan-22

Construction of future Claremont Park Road closes existing access up Brent Terrace North.

Access will be maintained across Claremont Green to Clitterhouse Crescent whilst Claremont Park is under construction.

BXT is designing options for an access route through the Exploratory (during opening hours access). This will require a new path through the Dixons Lands to the existing 'junction' north of the 'Costa Coffee' roundabout. Details of this route are still being developed to ensure that it is safe and well designed.

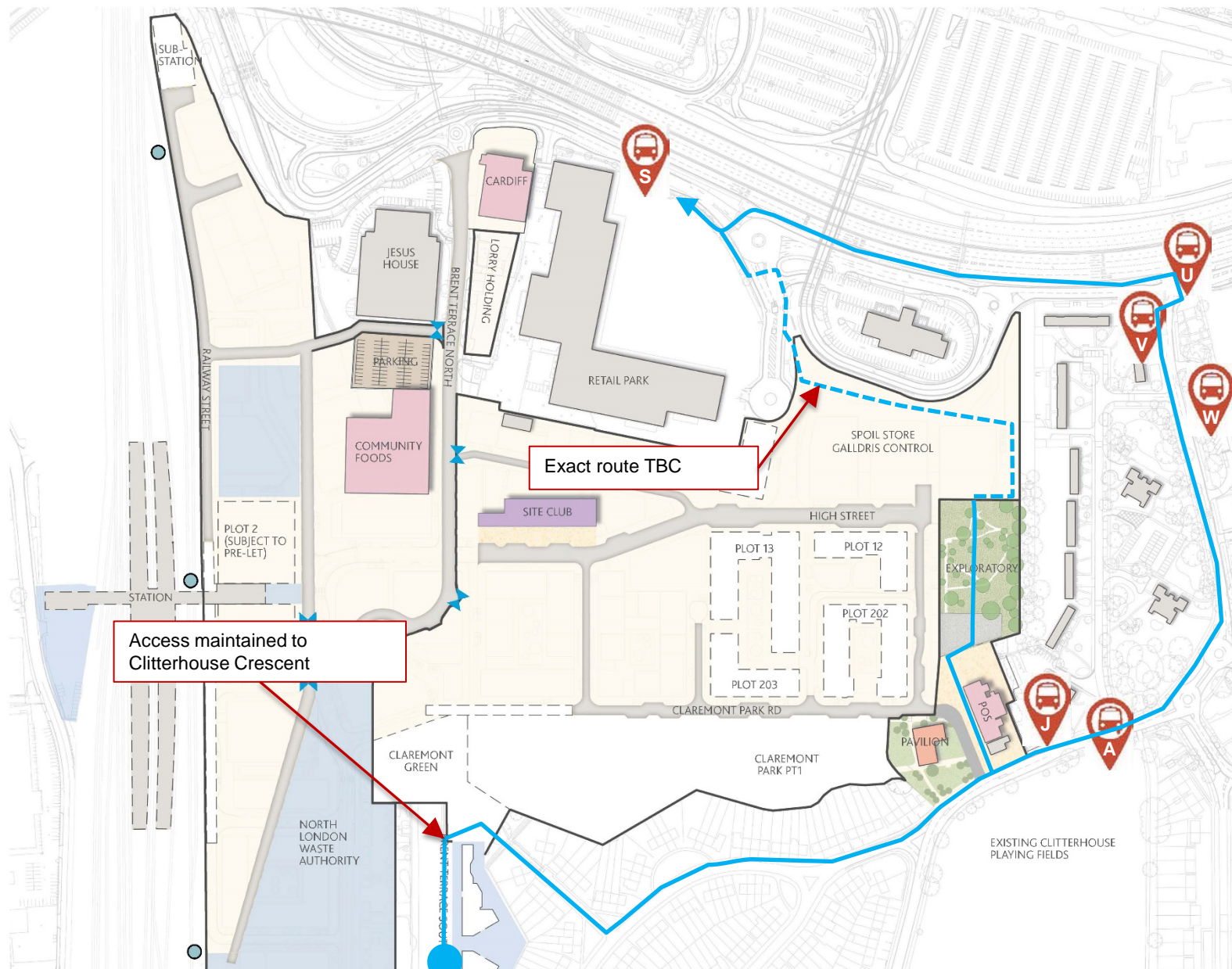

- KEY
- BXS control
- Hoarding line
- Existing use
- Interim use opportunity
- Site club
- Interim road
- Interim public realm
- Completed building
- Completed road
- Under construction
- Car Park
- NR access points (NAP)
- Gates

PROJECT TITLE  
BRENT CROSS SOUTH GUARDIAN ROLE - TIMESLICES

DRAWING TITLE  
P12174-00-003-GIL-0106-00

SCALE  
1:1250@A1

REVISION NO.  
00

DATE  
11 OCT 2020

**Bus Routes:**  
**Stop S:** 112, 142, 182, 232, 266 (All west bound only)  
**Stop U:** 324, 210  
**Stop V / W:** 102, 189, C11  
**Stop A / J:** 102, 189, C11  
**Stop TBC:** 189, 326

Apr-22

Claremont Park opens providing an alternative route during daylight hours.

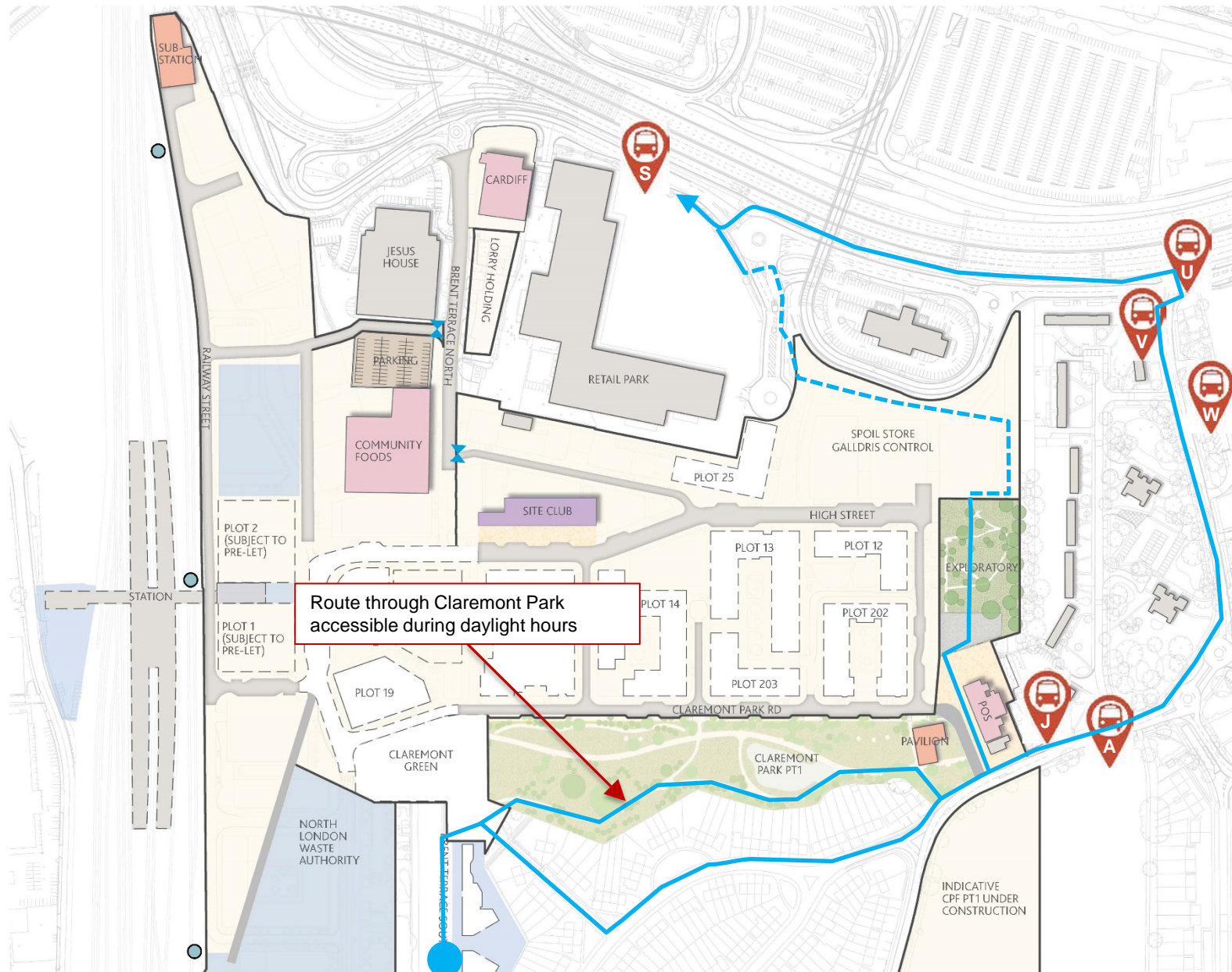

Route through Claremont Park accessible during daylight hours

- KEY
- DXS control
- Hoarding line
- Existing use
- Interim use opportunity
- Site club
- Interim road
- Interim public realm
- Completed building
- Completed road
- Under construction
- Car Park
- NR access points (NAP)
- Gates

PROJECT TITLE  
BRENT CROSS SOUTH GUARDIAN ROLE - TIMESLICES

DRAWING TITLE  
P12174-00-003-GIL-0107-00

SCALE  
1:1250 @ A1

REVISION NO.  
00

DATE  
11 OCT 2020

**Bus Routes:**  
**Stop S:** 112, 142, 182, 232, 266 (All west bound only)  
**Stop U:** 324, 210  
**Stop V / W:** 102, 189, C11  
**Stop A / J:** 102, 189, C11  
**Stop TBC:** 189, 326

Dec-22

Station now open.

“Station Approach” completes alongside the Station from which it will be possible to descend from the High Street down onto Brent Terrace North in this interim condition.

Bus stops serving the Station operational.



- KEY
- BXS control
- Hoarding line
- Existing use
- Station opened
- Interim use opportunity
- Site club
- Pedestrian access
- Interim road
- Interim public realm
- Completed building
- Completed public realm
- Completed road
- Under construction
- NR access points (NAP)
- Gates

PROJECT TITLE  
BRENT CROSS SOUTH GUARDIAN ROLE - TIMESLICES

DRAWING TITLE  
P12174-00-003-GIL-0100-05

SCALE  
1:1250@A1

REVISION NO.  
05

DATE  
11 OCT 2020

**Bus Routes:**  
**Stop S:** 112, 142, 182, 232, 266 (All west bound only)  
**Stop U:** 324, 210  
**Stop V / W:** 102, 189, C11  
**Stop A / J:** 102, 189, C11  
**Station Stops No. TBC:** 189, 326



# Future access after initial phases

In the final condition an all day, step free access route is provided via Station Approach and Tower Square.

An alternative access route will be provided through Plot 25 via steps/lift.



**LEGEND**

-  Step-free access route
-  Access route with lift, steps and cycle channel
-  On/off Street Cycle Route
-  Bus Stop
-  Step/ Lift

rev	details	by	date	rev	details	by	date
01	FOR WORKSHOP	WZ	14.04.2020				
02	FOR WORKSHOP	WZ	21.04.2020				
03	FOR WORKSHOP	WZ	22.04.2020				

**Notes**

- 1.0 Do not scale from drawing, use figured dimensions only
- 1.1 All dimensions to be checked onsite
- 1.2 This drawing to be read in conjunction with all other Gillespies drawings and specifications

Disclaimer & limitation: drawings are reproduced from Ordnance Survey material with the permission of Ordnance Survey on behalf of the Controller of Her Majesty's Stationery Office. © Crown Copyright. Unauthorised reproduction without Crown Copyright and may need a permission or copyright fee. Licence No. 100015762

**Project title**  
BRENT CROSS SOUTH  
MASTERPLAN REVIEW

**Drawing title**  
PEDESTRIAN & CYCLE ACCESS  
BETWEEN BRENT TERRACE AND  
TILLING ROAD

**Drawing number**  
P12174-00-001-GIL-0105

**Drawing Status**  
DESIGN

**Revision**  
02

**Date** 14.04.2020 **Scale** 1:1000 @ A1 **Drawn** WZ **Checked** R03BC

© copyright GILLESPIES LLP, all rights reserved

**GILLESPIES**

100 South Street, London EC1A 3DF  
T: 020 7546 6000 E: info@gillespies.com



# Programme and Sequencing

The above represents the anticipated programme and sequencing of the Brent Cross Town construction works.

Whilst this is market driven and subject to change we are committed to delivering to the principles of what is shown.

# Stopping-up status



Location	Description	Status
Claremont Way (East)	Existing Highway	Confirmed
Claremont Park	Existing Claremont Open Space	Objections
Clarefields Park	Existing Clarefields Park	Confirmed
Claremont Way (West)	Existing Highway and Public Footpath	Confirmed
Brent Terrace	Existing Highway	Being Advertised 19th November
106 footway	Existing Claremont Open Space	Being Advertised 19th November
Plot 53	Existing Park	Objections
Plot 54	Existing Park	Objections

# Claremont Park proposed landscape design

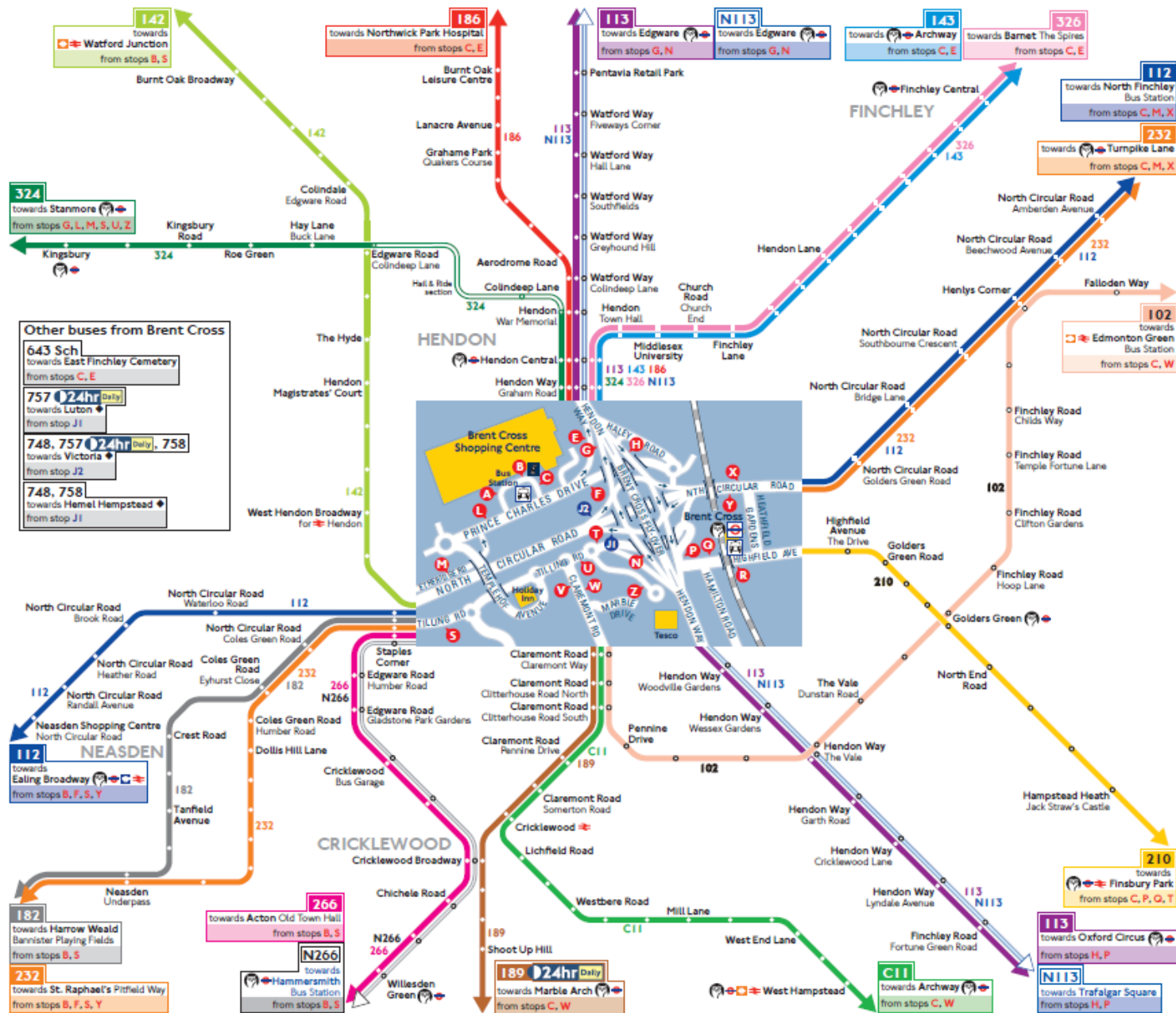

Figure 9: Claremont Park masterplan

Claremont Park Planning Application boundary

Note: details shown outside of planning application boundary are shown for information only

# Buses from Brent Cross



**Other buses from Brent Cross**

- 643 Sch towards East Finchley Cemetery from stops C, E
- 757 24hr Daily towards Luton from stop J1
- 748, 757 24hr Daily, 758 towards Victoria from stop J2
- 748, 758 towards Hemel Hempstead from stop J1

## How to use this map

- Find your destination on the map
- See the coloured lines on the map for the bus routes that go to your destination
- Check the map (at the end of each coloured line) for the bus stops to catch your bus from
- Use the central map to find the nearest bus stop for your route
- Look for the bus stop letters at the top of the stop (see example for stop A to the right)

## Key

	Connections with London Underground
	Connections with London Overground
	Connections with National Rail
	Taxi rank
	Tube station with 24-hour service Friday and Saturday nights
	Limited stop
	Sch School journeys only

## Ways to pay

- Use contactless (card or device). It's the same fare as Oyster pay as you go and you don't need to top up
- Download the free TFL app to top up or buy a ticket anytime, anywhere, or visit [tfl.gov.uk/oyster](https://tfl.gov.uk/oyster). Alternatively, find your nearest Oyster Ticket Stop at [tfl.gov.uk/ticketstopfinder](https://tfl.gov.uk/ticketstopfinder) or visit your nearest TFL station
- The Hopper fare offers you unlimited pay as you go Bus and Tram journeys within one hour for £1.50. Always use the same card or device to touch in
- If you fail to show on demand a ticket, validated smartcard or other travel authority valid for the whole of your journey you may be liable for a penalty fare or prosecuted.